

RPS-0143 09/00

For Date Codes Beginning with the Letter "E"

| Pendant Wiring | |
|----------------|--|
| Jog | Terminal 1 - White Terminal 2 - Black |

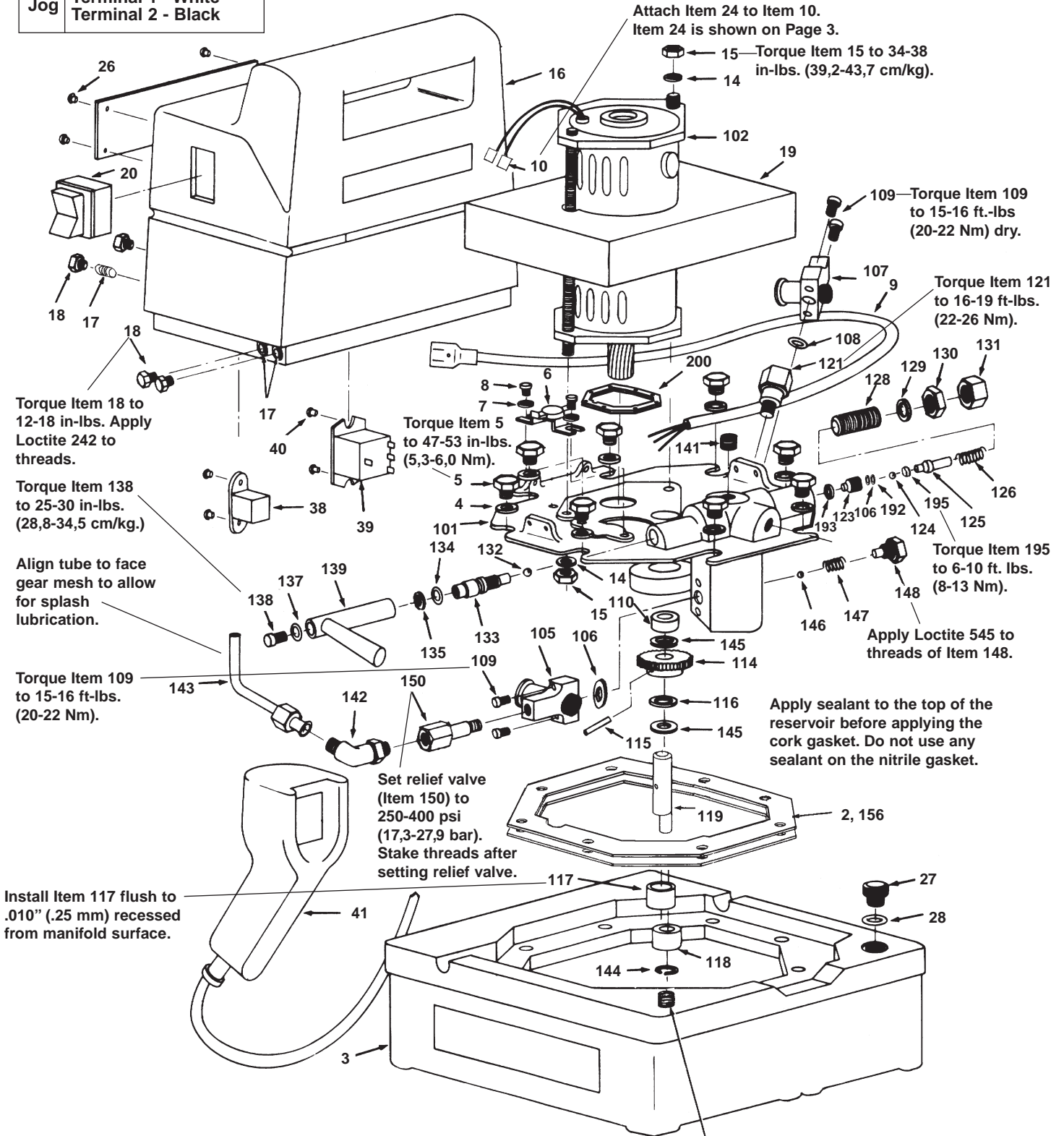

To Protect Your Warranty, Use Only Gardner Bender Hydraulic Oil.

GB recommends that all kit components be installed to insure optimum performance of the repaired product.

Repair Parts List for Figure 1

| Item | Part Number | Qty. | Description | Item | Part Number | Qty. | Description |
|------|-----------------|------|--|------|-------------|------|--------------------------------------|
| 2 | ★DA12088167SR | 1 | Gasket (includes Item 156) | 107 | CW299950SR | 1 | .24 Piston Block |
| 3 | DA1910900SR | 1 | Reservoir Assembly (For 1200, 4001 Versions) | 108 | ★B1012803 | 1 | O-ring |
| 4 | DA6954167 | 8 | Washer | 109 | B1008028 | 4 | Screw |
| 5 | DC2038028 | 8 | Screw | 110 | CW252107 | 1 | Bearing |
| 6 | E1100004 | 1 | Thermostat | 114 | CW301228 | 1 | Driven Gear |
| 7 | C701222 | 2 | Washer | 115 | ★B1097057 | 1 | Spring Pin |
| 8 | M692026 | 2 | Screw | 116 | CW199107 | 1 | Bearing |
| 9 | DA3709900SR | 1 | Power Cord (For "B" Versions) | 117 | CW251107 | 1 | Bearing |
| 10 | DA3776006 | 2 | Pin | 118 | CW302107 | 1 | Bearing |
| 11 | DA11539380 | 1 | Receptacle | 119 | CW303104 | 1 | Shaft |
| 14 | DA15066 | 3 | Lockwasher | 121 | DA5999900SR | 1 | Relief Valve |
| 15 | B1018121 | 3 | Hex Nut | 123 | DA12199290 | 1 | Ball Seat Insert |
| 16 | Contact Enerpac | | Shroud Assembly | 124 | ★B1004016 | 1 | Ball (.156 inch) |
| 17 | CW261225 | 6 | Eyelet | 125 | DC990900 | 1 | Ball Guide |
| 18 | F866028 | 6 | Screw | 126 | A109164 | 1 | Spring |
| 19 | CW259298 | 1 | Baffle | 128 | DA252028 | 1 | Adjustment Screw |
| 20 | E1500002 | 1 | Switch | 129 | ★S1167 | 2 | Gasket |
| 21 | DA3712900 | 2 | Wire Assembly | 130 | CW306055 | 1 | Lock Nut |
| 22 | DA3730900SR | 1 | Wire Assembly | 131 | CW307055 | 1 | Cap Nut |
| 23 | DA3711900SR | 1 | Wire Assembly | 132 | ★B1009016 | 1 | Ball (.312 inch) |
| 24 | DA11540380 | 1 | Receptacle | 133 | C790010SR | 1 | Stem |
| 26 | DC818003 | 4 | Pop Rivet | 134 | ★B1111203 | 1 | Viton O-ring |
| 27 | DA608024 | 1 | Vent Plug | 135 | ★B1111564 | 1 | Washer |
| 28 | ★B1906503 | 1 | O-ring | 137 | B1086066 | 1 | Lockwasher |
| 38 | E300006 | 1 | Transformer (For "B" Versions) | 138 | B1323028 | 1 | Socket Head Screw |
| 39 | E1300008 | 1 | Relay | 139 | DA544070SR | 1 | Handle |
| 40 | CW350003 | 4 | Pop Rivet | 141 | A1016245 | 1 | Plug |
| 41 | CR881900SR | 1 | Pendant Assembly | 142 | DA1011096 | 1 | Elbow |
| 42 | DA1973900SR | 1 | Wire Assembly | 143 | DA261268 | 1 | Tube |
| 43 | DA3713900SR | 1 | Wire Assembly | 144 | CW467044 | 1 | Retaining Ring |
| 44 | DA1975900SR | 1 | Wire Assembly | 145 | ★DA445107 | 2 | Bearing |
| 45 | DA1976900SR | 1 | Wire Assembly | 146 | ★B1007016 | 1 | Ball (.25 inch) |
| 67 | A1009245 | 1 | Plug | 147 | ★DA1564110 | 1 | Spring |
| 101 | DA12486840SR | 1 | Pump Manifold includes items 106, 121, 123, 148, 191, 193, 195 | 148 | DC433950 | 1 | Plug Assembly |
| 102 | CW179259 | 1 | Motor (For "B" versions) | 150 | DA610900SR | 1 | Relief Valve |
| 105 | CW298950SR | 1 | .53 Piston Block | 156 | ★See Item 2 | 1 | Gasket |
| 106 | ★B1007503 | 2 | O-ring | 190 | DC374900 | 1 | Choke Assembly (For "E" Versions) |
| | | | | 192 | B1012565 | 1 | Backup Washer |
| | | | | 193 | ★DC19503 | 1 | O-ring |
| | | | | 195 | DC866027 | 1 | Lock Screw |
| | | | | 200 | DC1947167 | 1 | Gasket |

★ Items included in and available only as part of Repair Kit PEM2000K.

REPAIR AND SERVICE INSTRUCTIONS: For repair service and parts contact your nearest **GB ELECTRICAL Service Center**. The **GB ELECTRICAL Service Center** will provide complete and prompt service on all **GB ELECTRICAL products**.

PARTS AND SERVICE: For quality workmanship and genuine GB ELECTRICAL parts, select an Authorized GB Service Center for your repair needs. Only repairs performed by an Authorized Service Center displaying the official GB Authorized sign are backed with full factory warranty. Contact GB Electrical (414) 352-4160 for the name of the nearest GB Authorized Service Center.

WARRANTY: Gardner Bender warrants its product against defects in workmanship and materials for 1 year from date of delivery to user. Chain is not warranted. Warranty does not cover ordinary wear and tear, abuse, misuse, overloading, altered products or use of improper fluid.

WARRANTY RETURN PROCEDURE: When question of warranty claim arises the user should send the unit to the nearest GB Authorized Service Center for inspection, transportation to be prepaid and evidence of purchase date furnished. If the claim comes under the terms of our warranty the Authorized Service Center will **REPAIR OR REPLACE PARTS AFFECTED** and return prepaid.



6101 North Baker Road, Milwaukee, WI 53209
Phone: (414) 352-4160 • Fax: (414) 352-2377

RPS-0143 9/00